

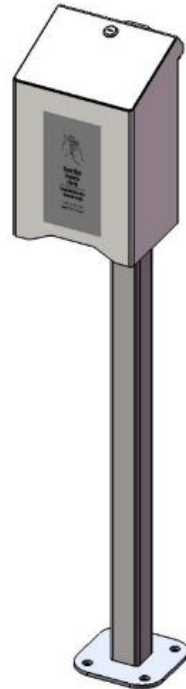

Large Touchless Hand Sanitizer Assembly Instructions

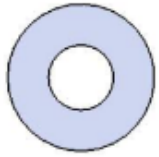

HARDWARE



5/16" WASHER



5/16" KEP NUT

TOOLS REQUIRED

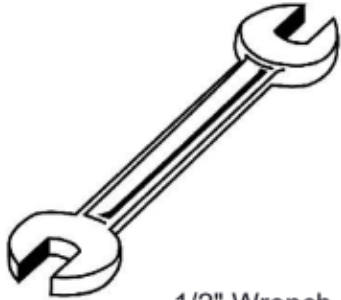

1/2" Wrench



1/2" Socket Wrench

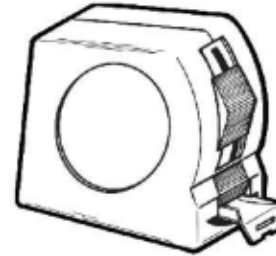

Tape Measure

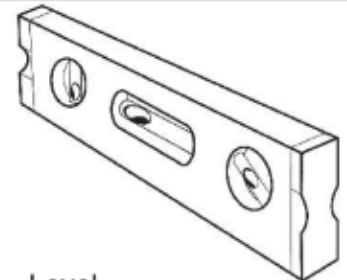

Level

Product Specifications

1011SM POST MOUNTED AUTOMATIC HOLDER

Dispenser Enclosure: 14 gauge steel. Enclosure includes lock.

Post: 2" square x 11ga pre-galvanized structural steel tubing. Surface mount plate is 6" x 6" x 1/4" steel plate. Mounting holes are spaced 4" apart, center to center. Electrically MIG welded.

Coating: Electrostatic powder coat, oven cured

Dispenser: 1000 ml automatic dispenser with lemongrass scented sanitizer.

Hardware: Stainless steel hardware fasteners.

Sanitizer Enclosure Dimensions: 8-3/8" wide x 6-3/4" deep x 13-1/2" tall

Overall Dimensions: 8-3/8" wide x 8-3/4" deep x 47" tall

COMPONENTS



⑩ - 01-05-0326 - Hand Sanitizer

Use this bottle to fill the gel tank inside the dispenser.

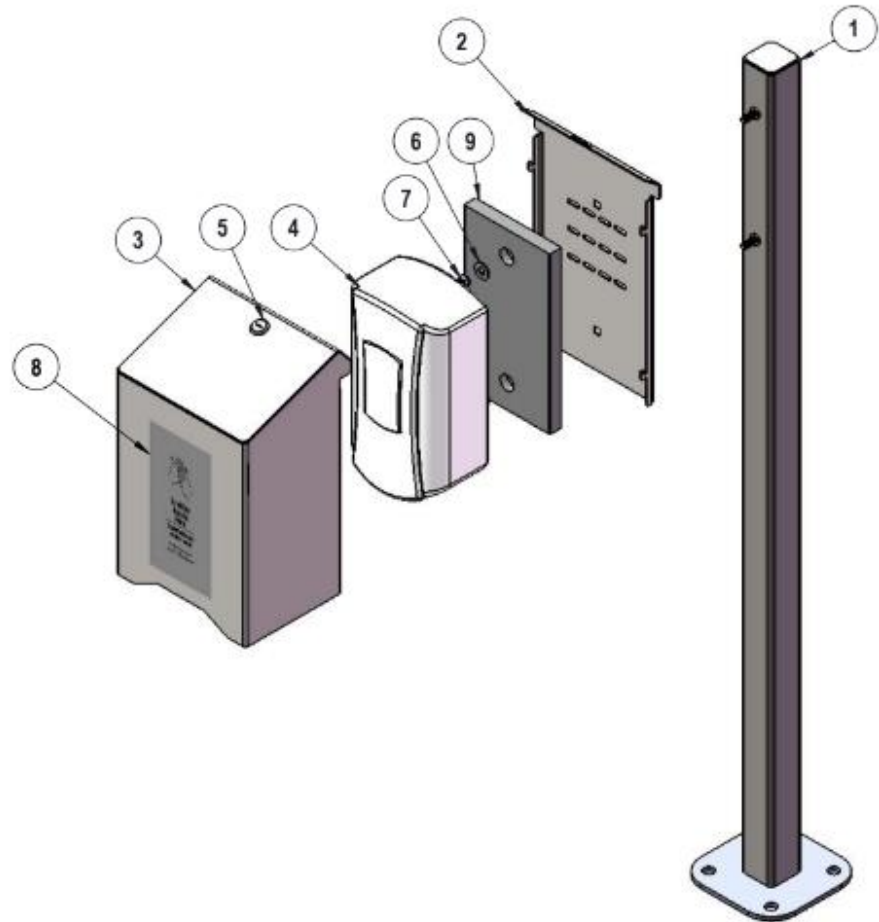

ITEM NO.	PartNo	DESCRIPTION	QTY.
1	01-05-0307	hand sanitizer post	1
2	01-05-0309	automatic dispenser hand sanitizer back	1
3	01-05-0311	automatic dispenser hand sanitizer front	1
4	01-05-0327	auto hand sanitizer dispenser	1
5	01-08-0106	Cabinet Lock w/ Keys (REF# VLT-080813-LM1)	1
6	33-02-0007	5/16" SS Washer	2
7	33-03-0012	5/16" Kep Nut (SS)	2
8	01-05-0312	sanitize hands here label	1
9	01-05-0315	automatic dispenser hand sanitizer spacer (1x6)	1
10	01-05-0326	hand sanitizer gel tank for manual/auto dispenser, lemongrass	1

OVERALL DIMENSIONS

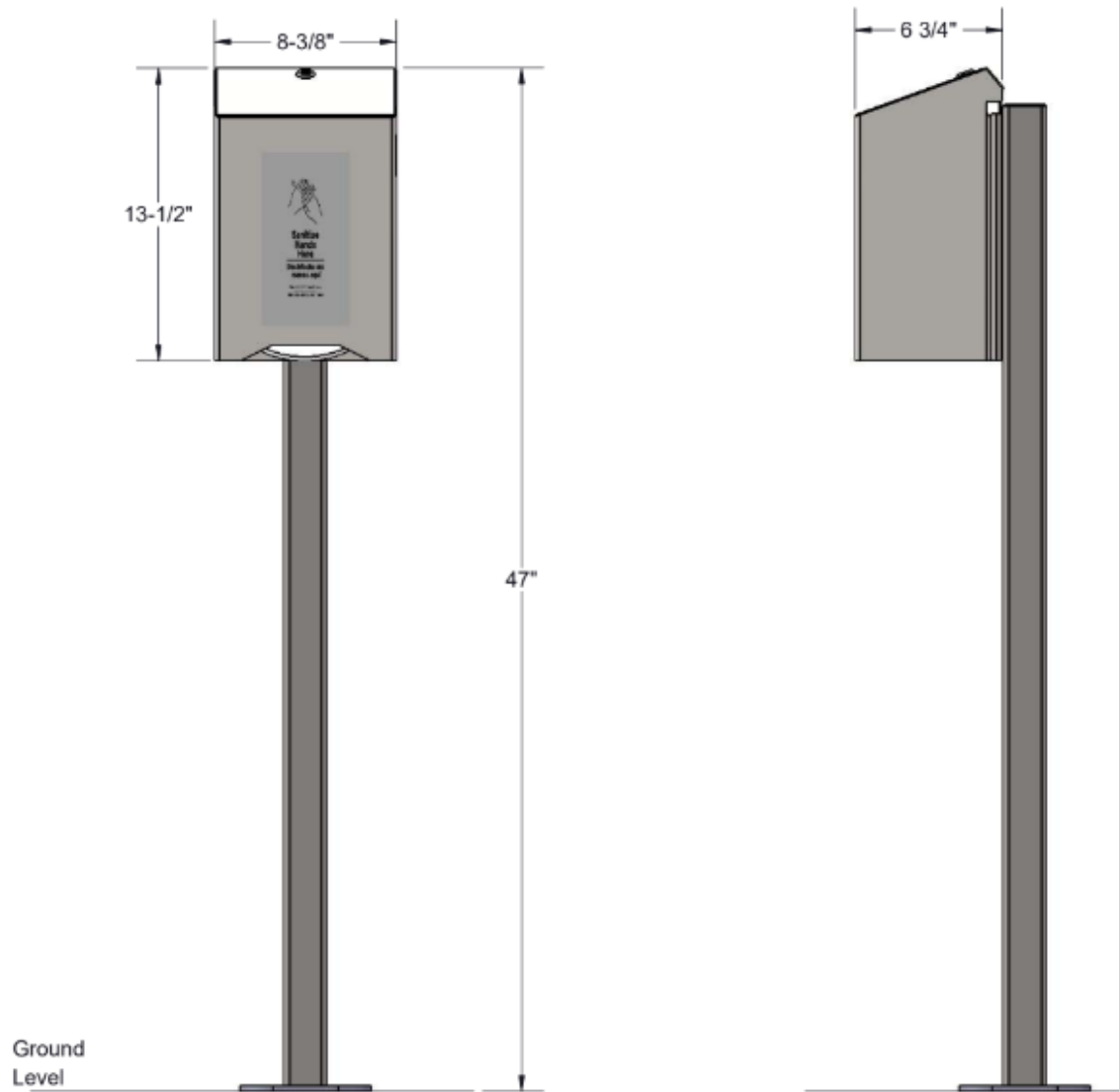

Assembly Steps

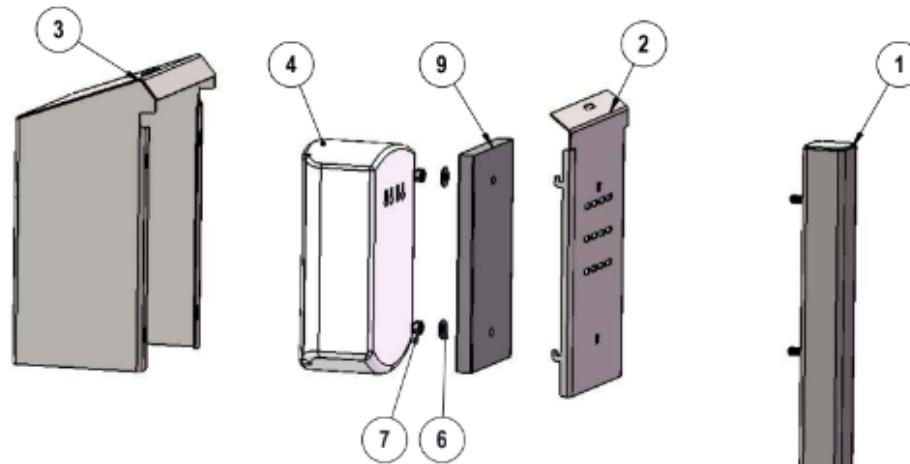

1. Attach enclosure back & spacer to post using specified hardware.
2. Attach dispenser to spacer and attach cover to back plate.
3. Apply label to front cover.

Anchor post to concrete using (4) 3/8" x 3-1/2" expansion anchor bolts (not included).

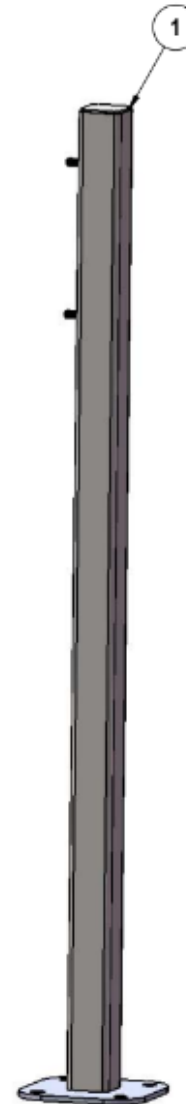



WARRANTY & TERMS

WARRANTY: 5 Year Limited Warranty on Thermoplastic coated elements. Ultra Play guarantees all items for one full year to be free of defects in workmanship or materials when installed and maintained properly. We agree to repair or replace, any items determined to be defective. Items specifically not covered by this warranty include vandalism, man made or natural disasters, lack of maintenance, normal weathering or wear and tear due to public abuse.

Damages or loss in transit is the responsibility of the carrier, whether visible or concealed. It is the responsibility of the recipient to assure that the order is received complete. Before signing the delivery receipt, inspect the shipment immediately and completely. Note any damages or shortages on the bill of lading. Damage reports must be filed within 10 days. Ultra Play is NOT responsible for damages or loss in transit. Title to all goods passes to the customer at the time of shipment. Ultra Play will assist in filing claims if the freight arrangements were made by Ultra Play at your request.

CANCELLATIONS AND RETURNS: Cancellations are only accepted with approval of Ultra Play. No merchandise shall be returned without a Return Goods Authorization number which is issued by customer service. Any authorized merchandise must be carefully packed and received in saleable condition. A restocking charge of up to 25% will be applied to all returned goods when the error is not the fault of Ultra Play. All returns must be shipped freight prepaid.