

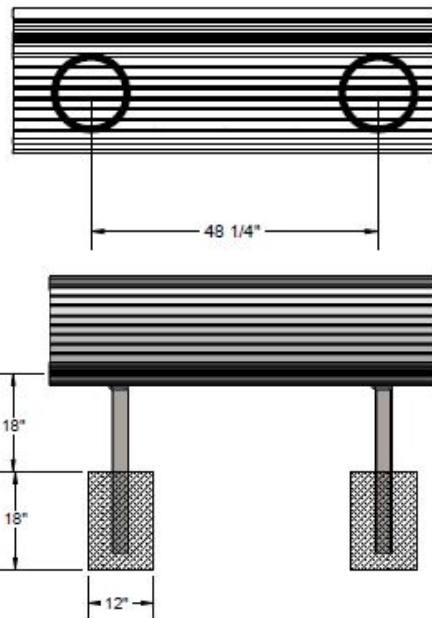

Footing



Parts List



Attach the 81 series seats to the 81 Frames using specified hardware.

Estimated Required Concrete:
7 - 50lb Bags of Concrete Mix

Dimensions

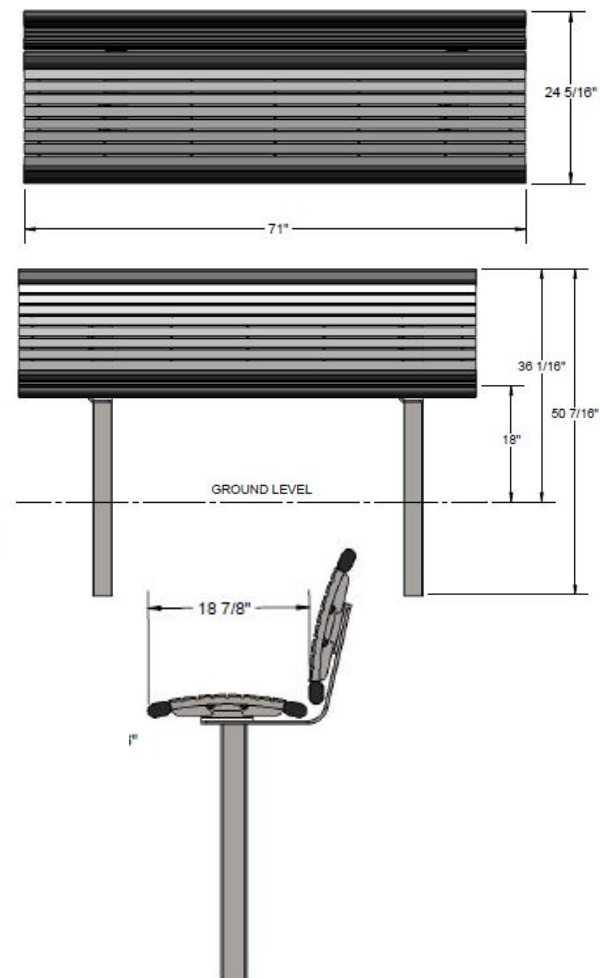

Hardware Included



3/8" x 1-1/2" MACHINE BOLT



3/8" FLAT WASHER



3/8" KEPNUT

Tools Required

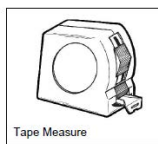

Tape Measure

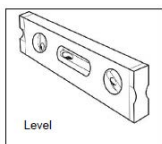

Level

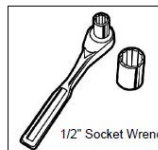

1/2" Socket Wrench

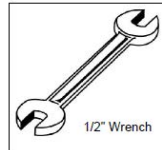

1/2" Wrench

ITEM NO.	PartNo	DESCRIPTION	QTY.
1	P-01-01-0412	81 Series S Leg	2
2	P-01-01-0415	81/82 Series Seat	2
3	33-05-0049	3/8" x 1 1/2" Machine Bolt (SS)	8
4	33-02-0008	3/8" Flat Washer (SS)	16
5	33-03-0013	3/8" Kep Nut (SS)	8

WARRANTY: OCCOutdoors, Inc. guarantees all items for one full year to be free of defects in workmanship or materials when installed and maintained properly. We agree to repair or replace, any items determined to be defective. Items specifically not covered by this warranty include vandalism, manmade or natural disasters, lack of maintenance, normal weathering or wear and tear due to public abuse.

NOTES:

1. INSTALLATION TO BE COMPLETED IN ACCORDANCE WITH MANUFACTURER'S SPECIFICATIONS.
2. ALL DIMENSIONS ARE CONSIDERED TRUE AND PERFECT MANUFACTURER'S SPECIFICATIONS.
3. DO NOT SCALE DRAWING.

This document contains OCC Outdoors Proprietary Information. No intellectual copyright or license is granted by OCC Outdoors in connection with it. It is delivered on the express condition that the document and the information contained in it shall be treated as confidential, shall not be used for and purpose other than that for which it is hereby delivered (the use and maintenance of the product supplied). It shall not be disclosed in whole or part to third parties and shall not be duplicated in any manner without OCC Outdoors's prior approval.

OCC Outdoors Products

PH: 1-800-821-7670

EMAIL - occcontact@occoutdoors.com Fax: 371-862-9422

Part #: OCC-81S-HS6

Date: 10/02/2015

OCC Outdoors Richmond
Steel In-Ground Mount
Bench with Back, No Arm
Rest