



Cans are constructed of 11Ga Galvannealed Steel,Fully welded & powder coated.
lock arms & receivers are made of 1/4 steel.
Cans are of moduler design to bolt together from one to five units.

Note.
Galvannealed steel is a Zinc coated steel.this helps to reduce rust.

Key Features

A	5 inch receiver hole.
B	Interchangeable plaques (optional) see plaque list.
C	Stainless Steel Hinge to prevent rusting
D	Zinc plated hardware to prevent rusting
E	Lockable Door (lock not included)
F	7/16 Dia holes on each side , for multiple unit assembly.
G	Lock arm guide bar (to prevent the arms from dropping & scratching the paint)
H	7/16 Dia holes in bottom plate for bolting to the mounting rails. see mounting rail list.
I	3/8 Dia holes in bottom plate for water drainage.
J	Plastic washers to prevent lock arms from scratching the paint
K	Lock arm receivers
L	Can mounting rails included. see Mounting rail list.

Tools required for Assembly

9/16 wrench	
1/4 Hex key	
3/32 Hex key	

Liner included

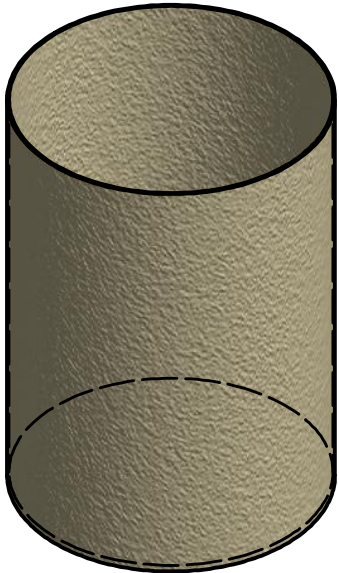

Plaque list



Recyclables
Cans/Bottles
Paper
Trash
Plastic
Landfill
Compost

Optional Recycle Mobius

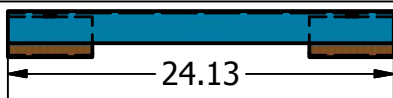
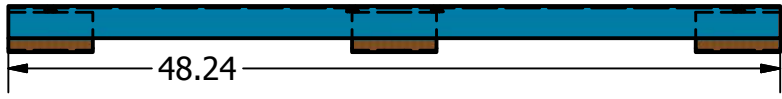

Mounting Rail list

Each rail assembly comes with a set of two channels
Mounting hardware included

One can rail	
Two can rail	
Three can rail	
Four can rail	
Five can rail	